



Type: **Z 400 G.5FA E2**

Part no.: F05-40013



**Curve:**

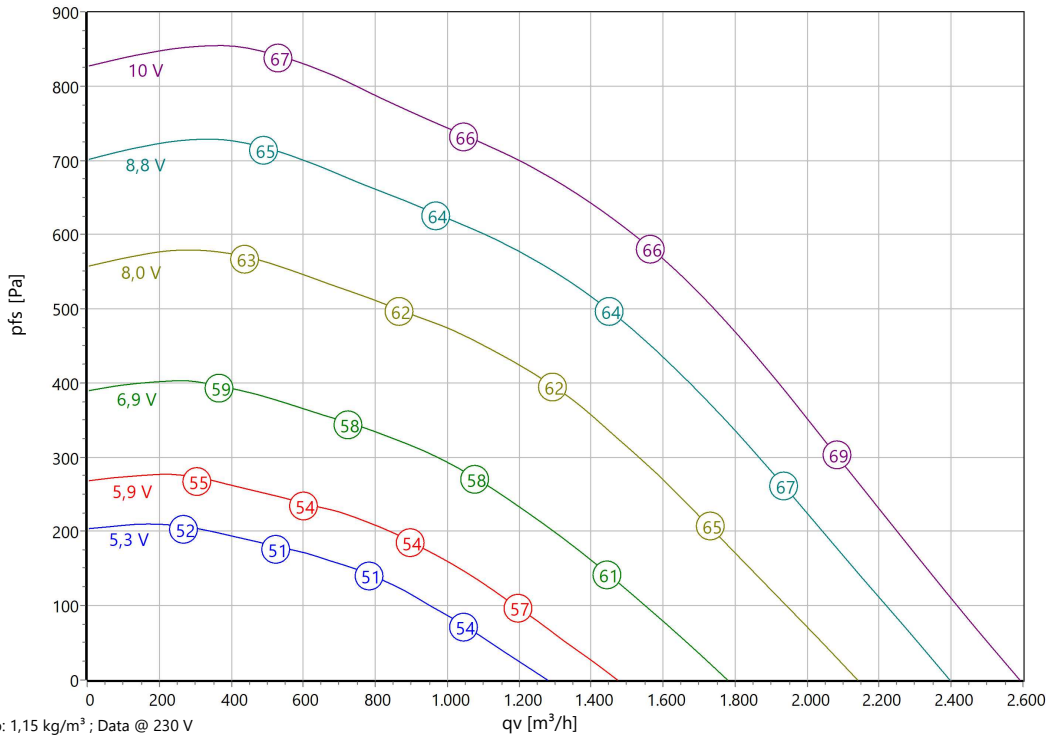

**ErP-Data:**

(EU) Nr. 1253/2014	(Lot6)	
qV	1410	m³/h
pfs	667	Pa
ηfs	46,9	%
Ped	0,557	kW
n	2600	r/min
N	50	
v	3,11	m/s
ηfs Lot11	58,7	%

**Nominal Data:**

U [V]	f [Hz]	Data @ [V]	Ped [kW]	IN [A]	nN [r/min]	tR [°C]	k10 [m²s/h]	Eff.-Rating	IP	m [kg]
1~200-277	50/60	230	0,6	2,6	2600	-25 .. +60	-	IE4	IP 44	40

**Sound Data:**

Frequency	Σ	125Hz	250Hz	500Hz	1kHz	2kHz	4kHz	8kHz	Distances	1 m	5 m
LwA(D,in) [dB(A)]		-6	-10	-7	-7	-8	-10	-19	LpA(D,in) [dB(A)]	-7	-18
LwA(D,out) [dB(A)]	20	-4	7	15	15	14	8	-4	LpA(D,out) [dB(A)]	13	1
LwA(D,cas) [dB(A)]	-6	-11	-10	-13	-20	-23	-34	-43	LpA(D,cas) [dB(A)]	-13	-24



Type: **Z 400 G.5FA E2**

Part no.: F05-40013

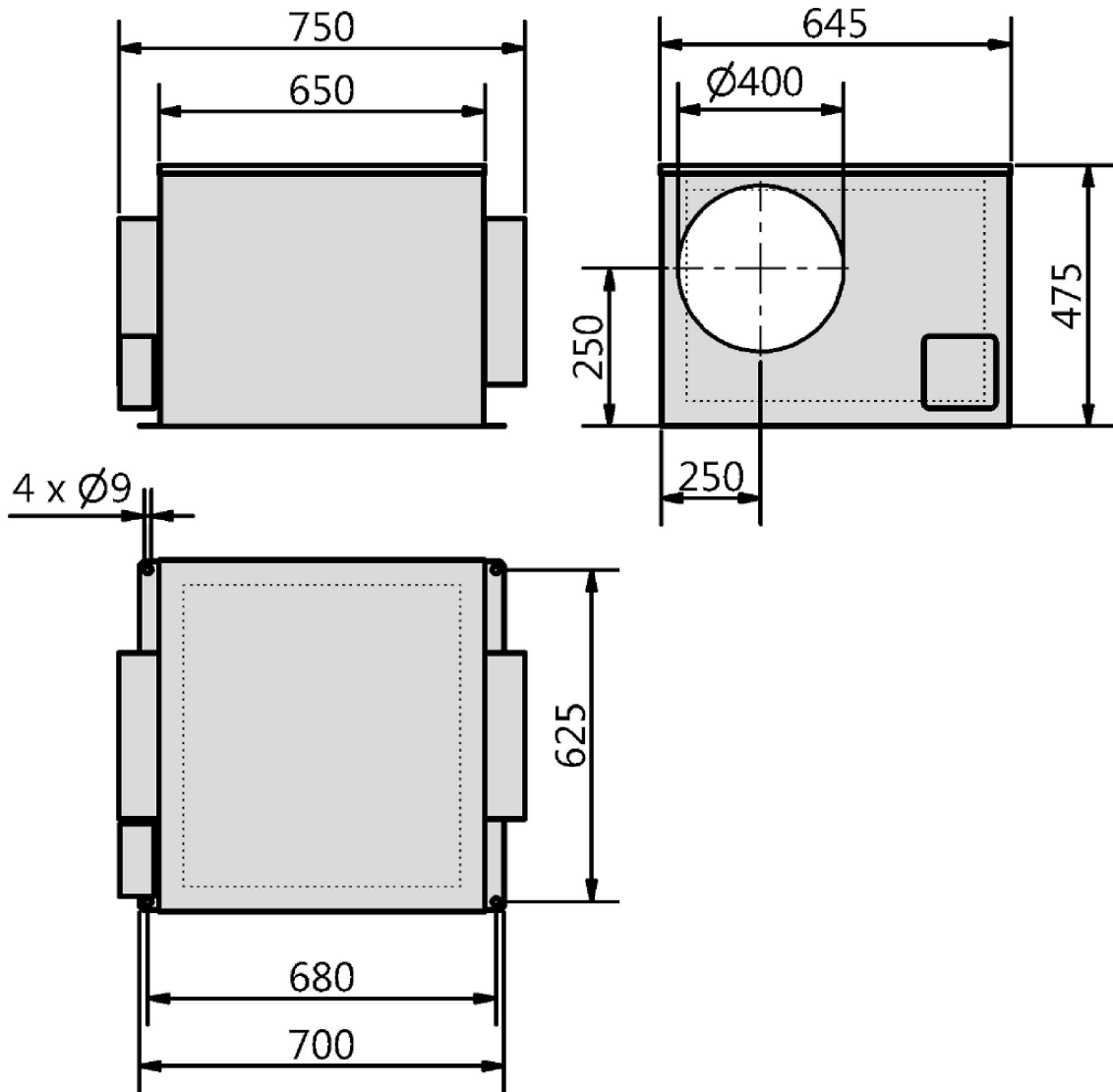



Type: **Z 400 G.5FA E2**

Part no.: F05-40013

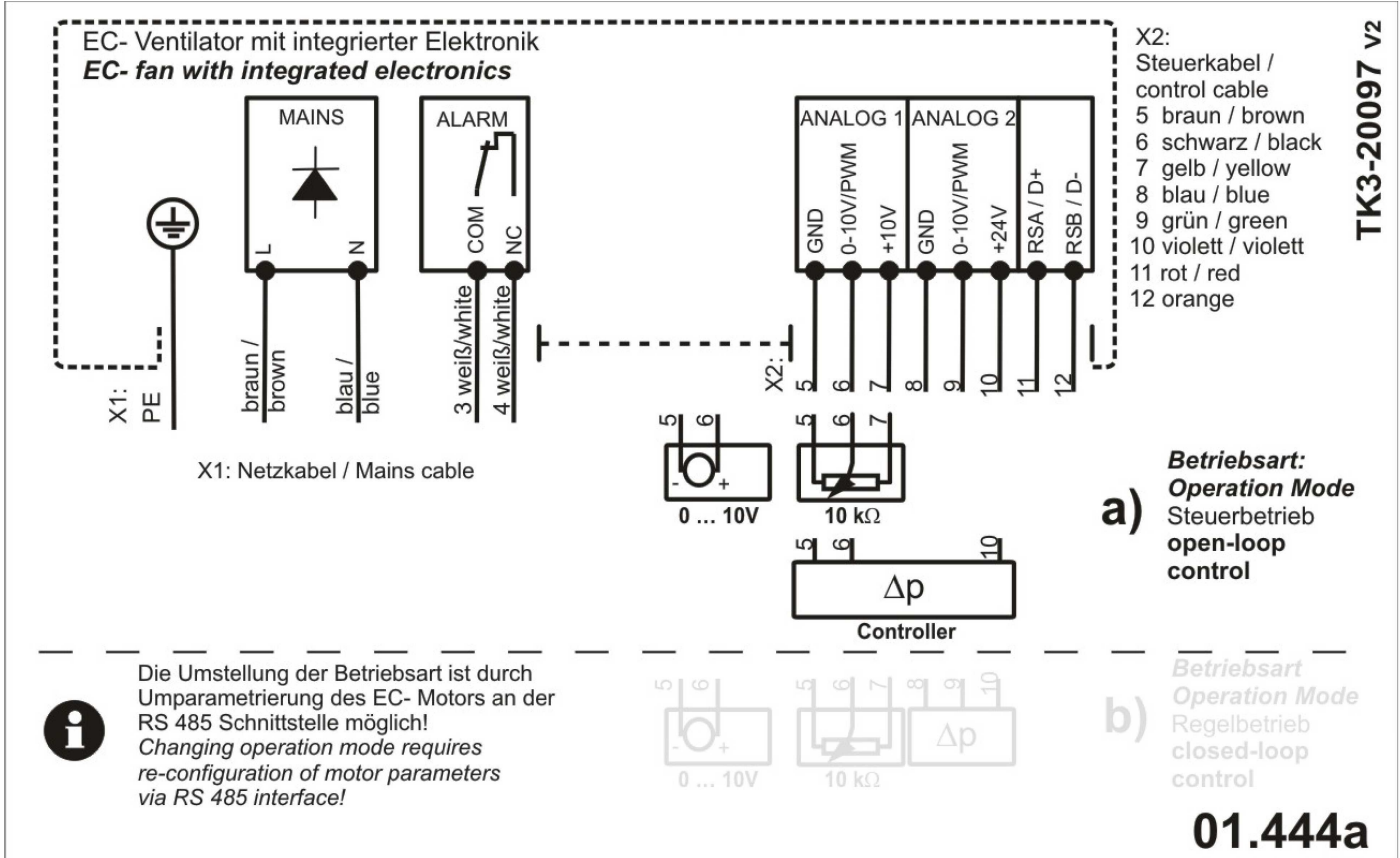

### Zerobox "Evolution"

Tube fans with sound-insulated housing

The flat casing made of galvanized sheet steel as sound absorbing construction. The inlayed 40mm thick rockwool plates have a sound attenuating effect. The covering lid can easily be unscrewed to gain access for cleaning and maintenance. The motor is removable together with the impeller and spiral scroll. Inlet and outlet side with duct connection for standard round ducts. Mounting either with horizontal or vertical motor shaft. Impeller made of aluminum (AlMg3) with backward curved blades. Energy saving EC external-rotor motor exceeds IE4 / Super Premium Efficiency. Maintenance free ball bearings, closed on both sides with long-term lubrication. Magnets without rare earth elements. Motor coated black and/or die casted aluminum. Protection Class IP54. 1-phase types with cable for supply and controlling and integrated active PFC (Power Factor Correction). 3-phase types with integrated terminal box and environmental resistant cable glands (3x M20x1,5). 100% speed controllable with integrated Motor Protection. ModBus RTU Interface integrated. Busconfiguration possible on site by customer. Soft Start. Potential-free Alarm Contact and integrated 24V Supply for Accessories. Applicable in all common energy grids. Low noise commutation. Motorized Impeller statically and dynamically balanced according to DIN ISO 21940-11 at least with quality level G6.3. The electrical connection is mounted on the housing by a terminal box. Air volume control is possible over an 0-10V Signal (accessory).

Fan complies with the guidelines required (Machinery-, EMC- and Low Voltage Directive) to comply with installation and conformity declaration as well as CE marking.

### Nominal Data:

Voltage  
1~200-277 V  
Frequency  
50/60 Hz  
Input power  
0,6 kW  
Current  
2,6 A  
Speed  
2600 r/min  
Medium temperature  
60 °C  
Protection Mode  
IP 44  
Efficiency Class  
IE4  
Weight  
40 kg  
Dimensions  
750 mm / 645 mm / 475 mm

### Contact:

Rosenberg Ventilatoren BV  
Elandlaan 8  
NL - 3734 CP Den Dolder  
[www.rosenberg.nl](http://www.rosenberg.nl)

**Type:**

Z 400 G.5FA E2

**Article-No.:**

F05-40013